

SAE STANDARD CONNECTIONS

# M23341

45° ISO/SAE CODE 61 FLANGE  
SAE J516 / ISO 12151-3

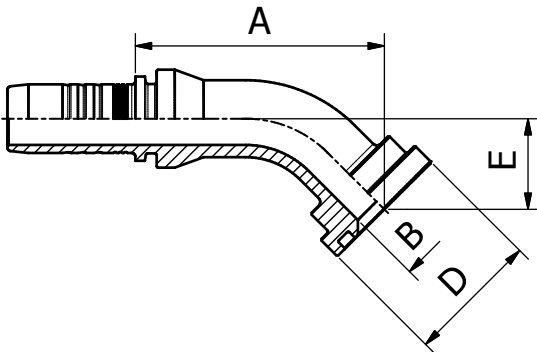

PART. REF.	HOSE BORE			FLANGE		DIMENSIONS mm						
	DN	Dash	inch	inch		B	A	D	E			
M23341-06-08	10	-6	3/8"	1/2"		9.3	52.5	30.0	17.5			
M23341-08-08	12	-8	1/2"	1/2"		9.3	58.5	30.3	18.5			
M23341-08-12	12	-8	1/2"	3/4"		15.0	59.5	38.0	19.0			
M23341-08-16	12	-8	1/2"	1"		19.8	59.5	44.6	19.0			
M23341-10-12	16	-10	5/8"	3/4"		15.0	61.0	38.0	22.0			
M23341-12-12	19	-12	3/4"	3/4"		15.0	71.0	38.0	26.0			
M23341-12-16	19	-12	3/4"	1"		20.0	68.5	44.6	23.0			
M23341-16-12	25	-16	1"	3/4"		15.0	74.5	38.0	23.0			
M23341-16-16	25	-16	1"	1"		19.8	81.5	44.6	27.5			
M23341-16-16032	25	-16	1"	1"		19.8	86.0	44.5	32.0			
M23341-16-20	25	-16	1"	1.1/4"		26.0	81.5	51.0	27.5			
M23341-20-16	31	-20	1.1/4"	1"		19.8	84.5	44.6	29.5			
M23341-20-20	31	-20	1.1/4"	1.1/4"		26.0	92.0	51.0	29.5			
M23341-20-20038	31	-20	1.1/4"	1.1/4"		26.0	100.5	50.9	38.0			
M23341-20-24	31	-20	1.1/4"	1.1/2"		32.0	93.5	60.5	31.0			
M23341-24-24	38	-24	1.1/2"	1.1/2"		32.0	107.5	60.5	34.5			
M23341-24-24044	38	-24	1.1/2"	1.1/2"		32.0	117.0	60.5	44.0			
M23341-24-32	38	-24	1.1/2"	2"		42.0	107.5	71.6	34.5			
M23341-32-20	51	-32	2"	1.1/4"		26.0	128.5	51.0	32.0			
M23341-32-32	51	-32	2"	2"		42.0	124.0	71.6	39.0			
M23341-32-32056	51	-32	2"	2"		42.0	141.0	71.5	56.0			
M23341-32-40	51	-32	2"	2.1/2"		56.0	136.5	84.3	49.5			
M23341-40-32	63	-40	2.1/2"	2"		42.0	152.0	71.6	48.5			
M23341-40-40	63	-40	2.1/2"	2.1/2"		52.0	95.0	84.3	48.5			
M23341-40-40A140	63	-40	2.1/2"	2.1/2"		52.0	141.0	84.3	46.0			
M23341-40-48	63	-40	2.1/2"	3"		61.0	117.5	101.6	53.5			
M23341-48-48	76	-48	3"	3"		58.0	125.5	101.6	53.5			
M23341-56-56	89	-56	3.1/2"	3.1/2"		79.0	139.0	114.3	68.0			
M23341-56-64	89	-56	3.1/2"	4"		79.0	124.5	127.0	53.5			
M23341-64-64	102	-64	4"	4"		90.0	132.0	127.0	56.5			

All items are made from solid with the exception of M23341-40-40, M23341-40-48, M23341-48-48, M23341-56-56, M23341-56-64, M23341-64-64.